

# Single pivot hinge with knuckle

- ▶ **Selekta**
- ▶ **Technical and fitting information**

## Number of hinges per door

Door width, height and weight as well as the material quality of the door are decisive factors determining the number of hinges required. The factors encountered in practice differ widely from case to case. For this reason, the number of hinges specified in the diagram must be understood as a guide only. If in doubt, it is recommended to carry out a trial door mounting and adjust the number of hinges as necessary.

For reasons of stability, distance X between the hinges must always be made as large as possible. On doors with two hinges, the distance between hinges must be at least equal to the width of the door. An additional hinge approx. 100 mm below the upper hinge is recommended for particularly heavy doors.

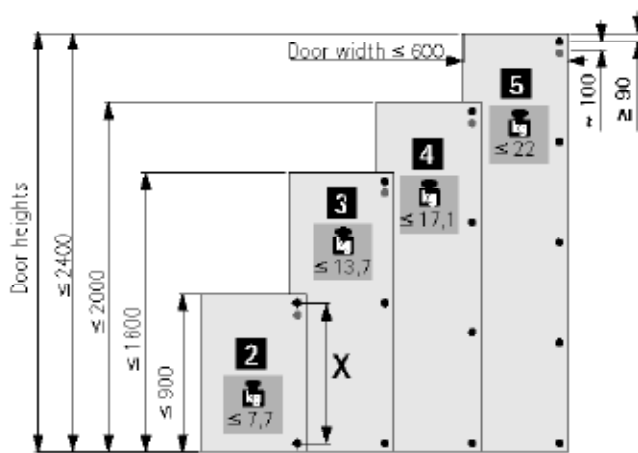

## Drilling pattern for base hinge

For overlay doors, for hinges using System 32

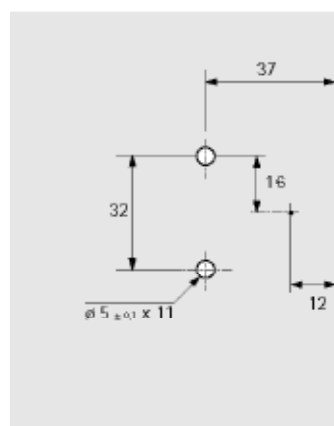

For overlay doors, for hinges using System 25

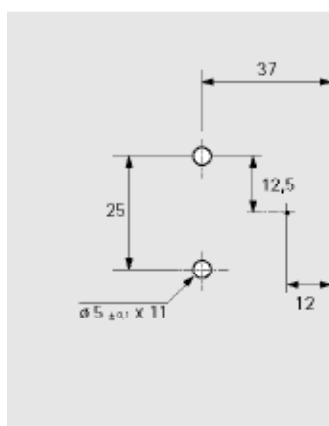

Production tolerances shown in the drawing must be kept.

The drill hole positions must be set back by 20 mm for inset doors.

## Cup tolerances

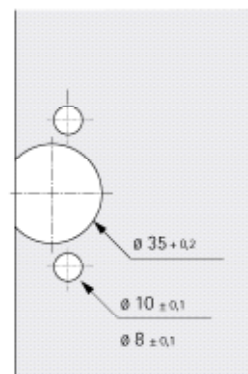

Production tolerances shown in the drawing must be kept.